

FOR LEASE

MISSION ESCONDIDO CENTER

205 W Mission Ave, Escondido, CA

- CENTRALLY LOCATED 40,000 SF RETAIL / OFFICE CENTER
- CONVENIENT ACCESS TO:  
- LOCALLY OWNED AND PROFESSIONALLY MANAGED
- TRAFFIC COUNTS OF 22,000 CARS PER DAY ALONG MISSION

AVAILABLE: 940 / 1,993 SF

AVAILABLE

IDEAL FOR: RETAIL, OFFICE, MEDICAL OFFICE, INSURANCE, ATTORNEYS, TUTORING, AND MORE.

For more information about this property, please contact:

Rob Bloom
(619) 269-6076
Rob@DuhsCommercial.com
CA License: 01302163

Scott Duhs
(619) 491-0614
Scott@DuhsCommercial.com
CA License: 01048874



COMMERCIAL
BROKERAGE • INVESTMENT • DEVELOPMENT



SITE PLAN

MISSION ESCONDIDO CENTER

205 W Mission Ave, Escondido, CA

W. Mission Avenue

22,000 Cars Per Day

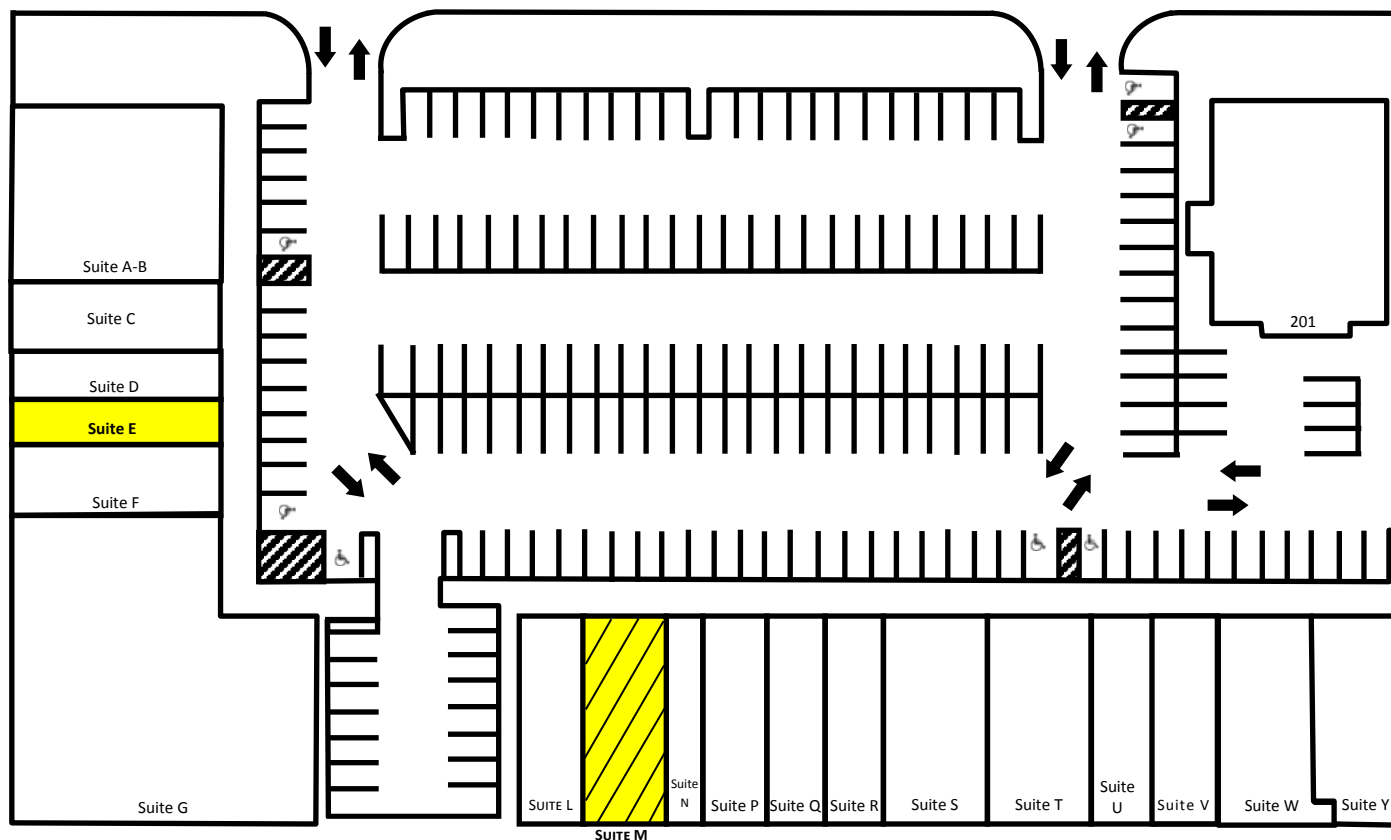

SUITE	TENANT	SF
A-B	Rent - A - Wheel	4,128
C	Casino Training	1,310
D	Minuteman Press	1,062
E	Day Spa (Potentially Available)	940
F	United Cerebral Palsy	1,585
G	United Cerebral Palsy	8,948
L	Detailing Supplies	1,367
M	AVAILABLE	1,993
N	Rocco's Pizza & Deli	733
P	Chiropractor	1,389
Q	Mexican Food	1,304
R	Mexican Food	1,366
S	Loans & Jewelry	2,172
T	Chinese Market	2,402
U	Thai Restaurant	1,360
V	Dentist	1,415
W-Y	San Diego County	3,999
201	Mediterranean Restaurant	4,300

For more information about this property, please contact:

Rob Bloom
 (619) 269-6076
 Rob@DuhsCommercial.com
 CA License: 01302163

Scott Duhs
 (619) 491-0614
 Scott@DuhsCommercial.com
 CA License: 01048874



AERIAL

MISSION ESCONDIDO CENTER

205 W Mission Ave, Escondido, CA



For more information about this property, please contact:

Rob Bloom
 (619) 269-6076
 Rob@DuhsCommercial.com
 CA License: 01302163

Scott Duhs
 (619) 491-0614
 Scott@DuhsCommercial.com
 CA License: 01048874



FLOOR PLAN

MISSION ESCONDIDO CENTER

205 W Mission Ave, Escondido, CA

SUITE M 1,993 SF

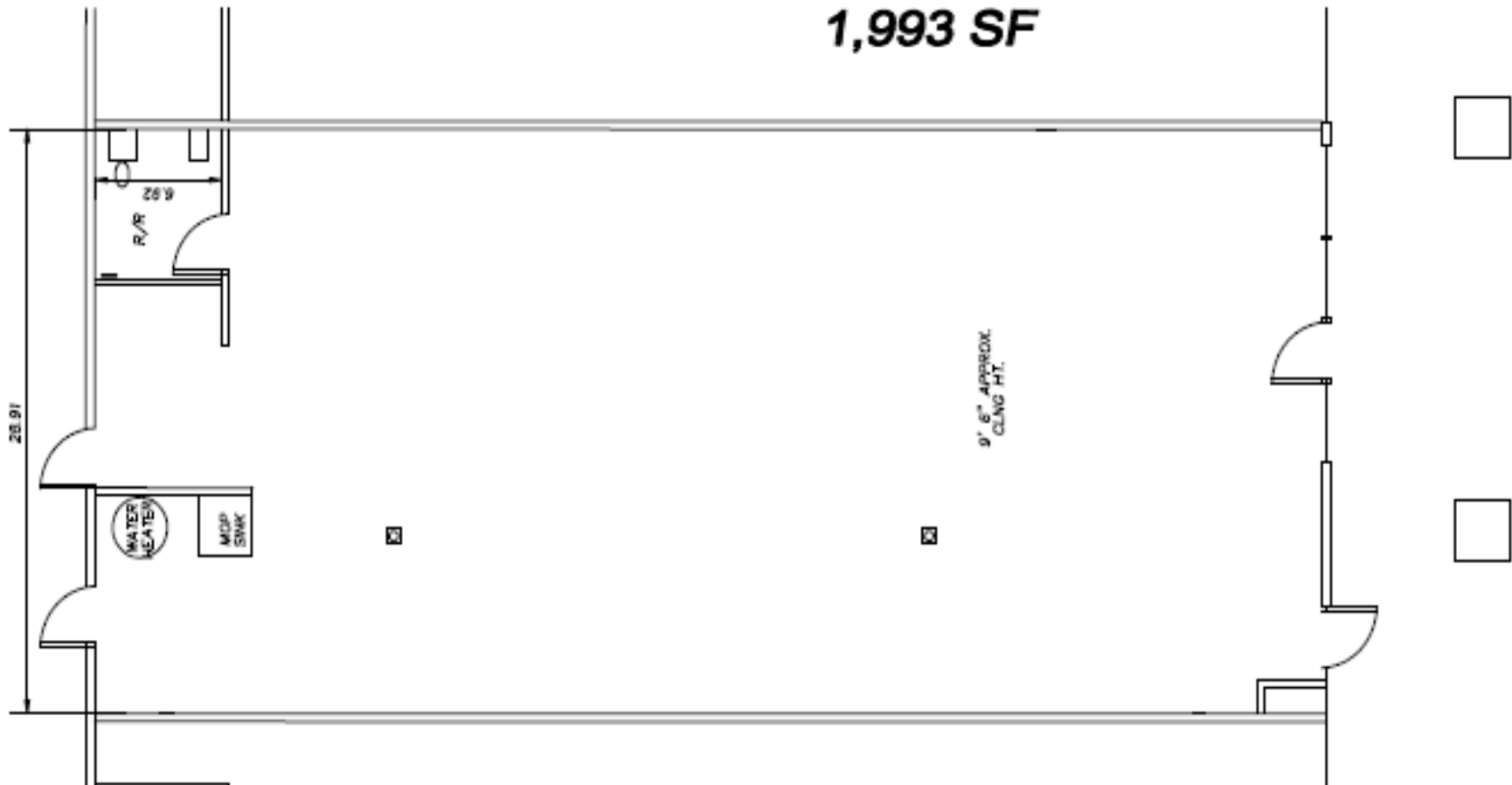

For more information about this property, please contact:

Rob Bloom
(619) 269-6076
Rob@DuhsCommercial.com
CA License: 01302163

Scott Duhs
(619) 491-0614
Scott@DuhsCommercial.com
CA License: 01048874

