

FOR LEASE

314-328 BROADWAY, RENO NV 89502

AVAILABLE: 720 SF

- OFF THE WELLS AVENUE CORRIDOR
- MIDTOWN LOCATION
- PARKING RATIO - 1.40/1,000 SF



DEMOGRAPHICS: (2017)

	<u>1Mile</u>	<u>3Miles</u>	<u>5Miles</u>
Total Population:	22,708	123,130	235,579
Avg. HH Income:	\$47,415	\$55,981	\$62,848

TRAFFIC COUNT:

S Wells Ave	25,550 ADT (2011)
Broadway	2,300 ADT (2016)

For more information about this property, please contact owner:

Craig Duhs
(619) 540-1001
Craig@DuhsCommercial.com
CA License: 01086079



COMMERCIAL
BROKERAGE • INVESTMENT • DEVELOPMENT



No warranty or representation is made to the accuracy of the foregoing information. Terms of sale or lease and availability are subject to change or withdrawal without notice.

3830 Ray Street, San Diego, CA 92104 | Phone (619) 491-0335 | Fax (619) 491-0696 | www.DuhsCommercial.com

SITE PLAN

314-328 BROADWAY, RENO NV 89502

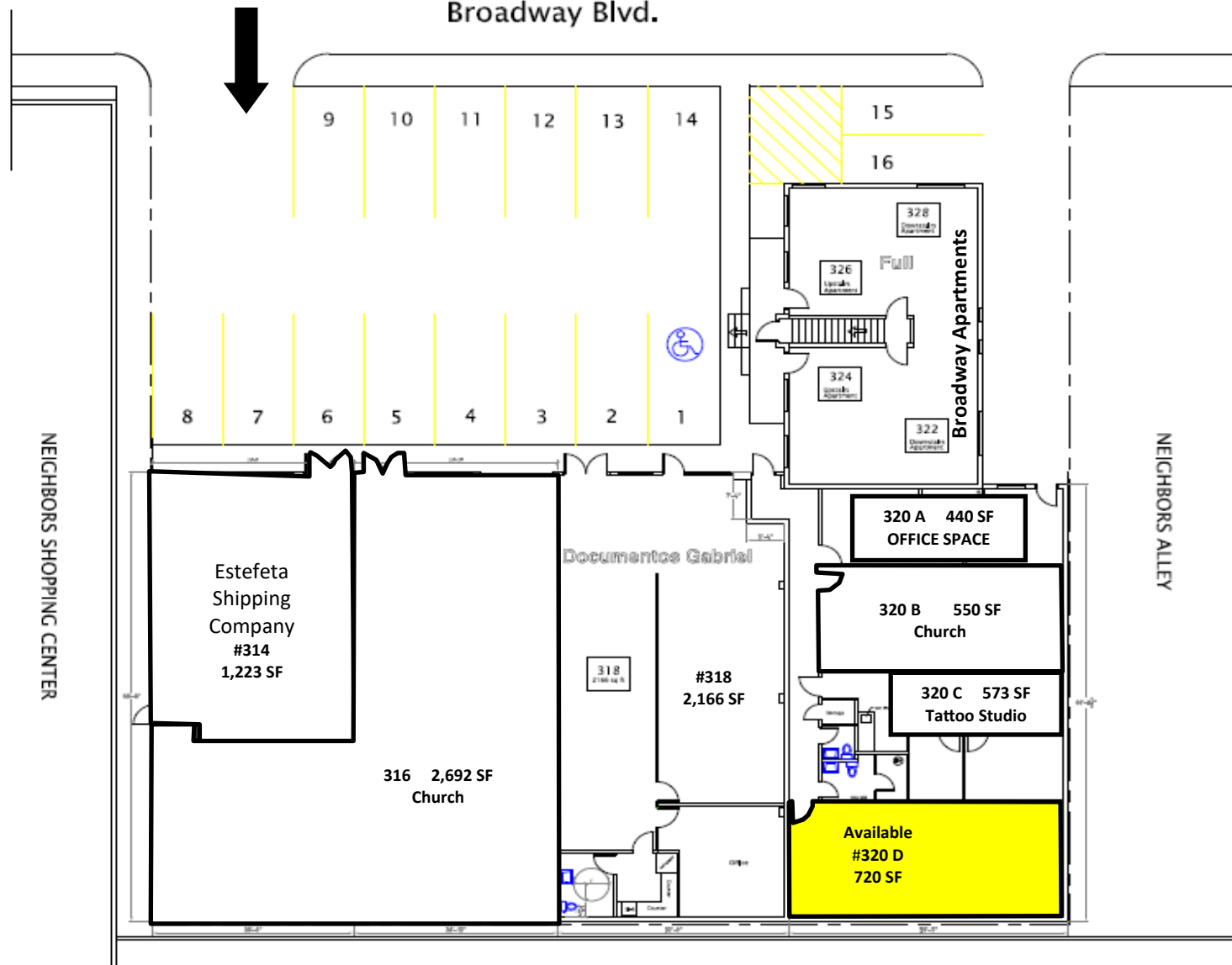

Broadway - Retail

SUITE	Tenant	SF
314	Estefeta Shipping Company	1,223
316	Church	2,692
318	Tax Accounting	2,166
320 A	Office Space	440
320 B	Church	550
320 C	Tattoo Studio	573
320 D	Available	720
TOTAL		8,352

Broadway - Apartments

SUITE	SF
322	630
324	630
326	630
328	630
TOTAL	2,520

Scale: 1/16" = 1' - 0"

For more information about this property, please contact owner:

Craig Duhs
 (619) 540-1001
 Craig@DuhsCommercial.com
 CA License: 01086079



COMMERCIAL
 BROKERAGE • INVESTMENT • DEVELOPMENT

AERIAL

314-328 BROADWAY, RENO NV 89502



For more information about this property, please contact owner:

Craig Duhs
(619) 540-1001
Craig@DuhsCommercial.com
CA License: 01086079



COMMERCIAL
BROKERAGE • INVESTMENT • DEVELOPMENT

No warranty or representation is made to the accuracy of the foregoing information. Terms of sale or lease and availability are subject to change or withdrawal without notice.

3830 Ray Street, San Diego, CA 92104 | Phone (619) 491-0335 | Fax (619) 491-0696 | www.DuhsCommercial.com