

FOR LEASE BY OWNER

314-328 BROADWAY, RENO NV 89502

- OFF THE WELLS AVENUE CORRIDOR
- MIDTOWN LOCATION
- PARKING RATIO - 1.40/720 SF



DEMOGRAPHICS: (2022)

| | <u>1Mile</u> | <u>3Miles</u> | <u>5Miles</u> |
|-------------------|--------------|---------------|---------------|
| Total Population: | 23,702 | 128,209 | 243,335 |
| Avg. HH Income: | \$61,377 | \$69,791 | \$77,153 |

TRAFFIC COUNT:

| | |
|-----------------|-------------------|
| S Wells Ave | 12,887 ADT (2022) |
| S. Virginia St. | 20,305 ADT (2022) |

For more information about this property, please contact owner:

Craig Duhs
(619) 540-1001
Craig@DuhsCommercial.com
CA License: 01086079



No warranty or representation is made to the accuracy of the foregoing information. Terms of sale or lease and availability are subject to change or withdrawal without notice.

3830 Ray Street, San Diego, CA 92104 | Phone (619) 491-0335 | Fax (619) 491-0696 | www.DuhsCommercial.com



SITE PLAN

314-328 BROADWAY, RENO NV 89502

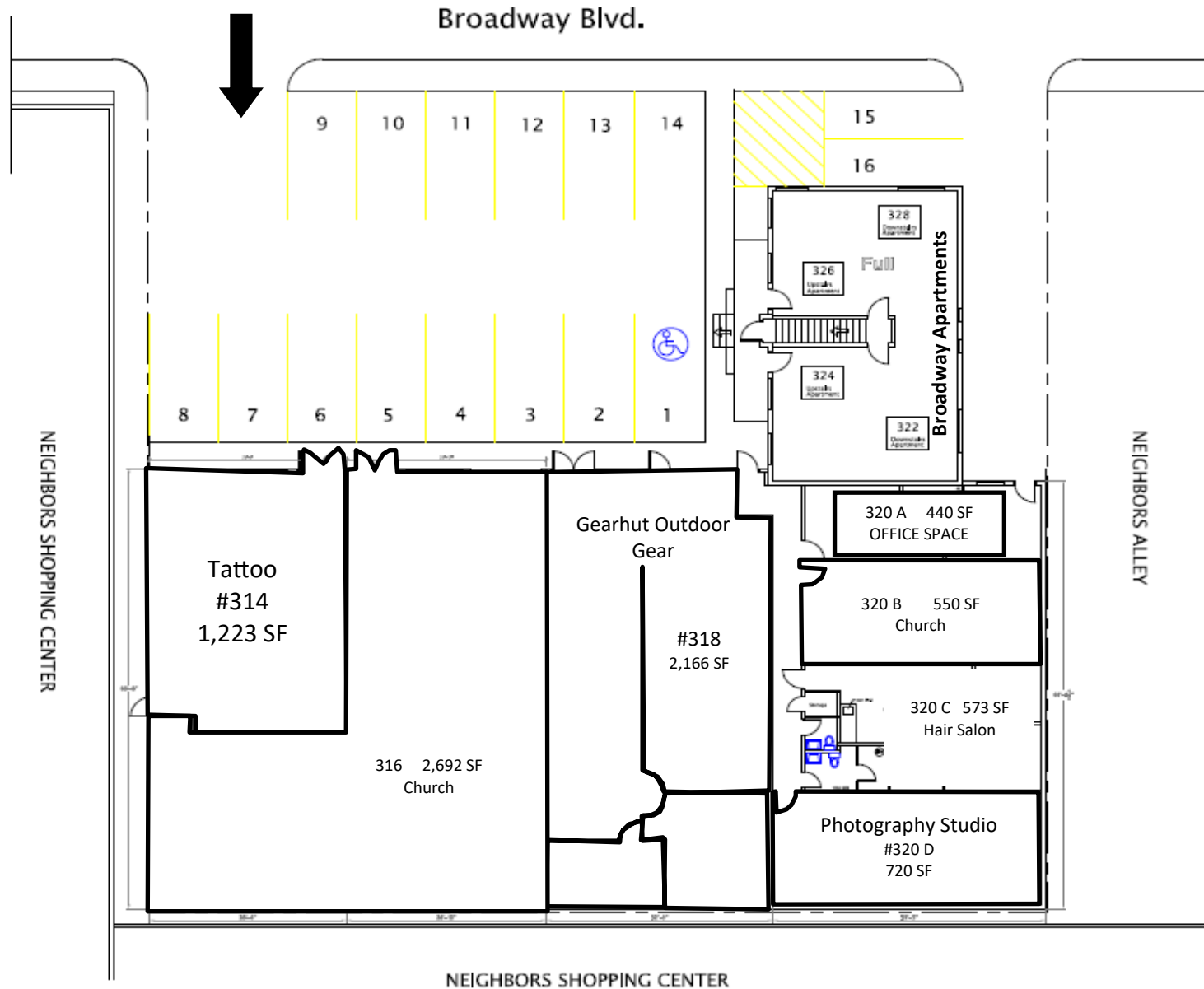

Broadway - Retail

| SUITE | Tenant | SF |
|--------------|----------------------|--------------|
| 314 | Tattoo | 1,223 |
| 316 | Church | 2,692 |
| 318 | Gearhut Outdoor Gear | 2,166 |
| 320 A | Office Space | 440 |
| 320 B | Church | 550 |
| 320 C | Hair Salon | 573 |
| 320 D | Photography Studio | 720 |
| TOTAL | | 8,352 |

Broadway - Apartments

| SUITE | SF |
|--------------|--------------|
| 322 | 630 |
| 324 | 630 |
| 326 | 630 |
| 328 | 630 |
| TOTAL | 2,520 |

NOT DRAWN TO SCALE



COMMERCIAL
BROKERAGE • INVESTMENT • DEVELOPMENT

AERIAL

314-328 BROADWAY, RENO NV 89502



For more information about this property, please contact owner:

Craig Duhs
(619) 540-1001
Craig@DuhsCommercial.com
CA License: 01086079



No warranty or representation is made to the accuracy of the foregoing information. Terms of sale or lease and availability are subject to change or withdrawal without notice.

3830 Ray Street, San Diego, CA 92104 | Phone (619) 491-0335 | Fax (619) 491-0696 | www.DuhsCommercial.com