

# FOR LEASE

## SABRE SPRINGS PLAZA

11385-11395 Poway Road, San Diego, CA

- Excellent Visibility Along Poway Road
- Easy & Convenient Access at Signalized Intersection
  - “Going Home” Side of the Street
- Plenty of Parking (5.1 : 1,000 SF)
- Affluent Demographics— \$129,776 Avg. Household Income
- Join 7-Eleven and Excellent Mix of Other Retail Services



2 miles

Poway Road  
37,549 Cars Per Day

1,040-1,200 SF (Can be Combined for 2,240 SF)

For more information about this property, please contact:

Rob Bloom  
(619) 269-6076  
Rob@DuhsCommercial.com  
CA License: 01302163

Scott Duhs  
(619) 491-0614  
Scott@DuhsCommercial.com  
CA License: 01048874



COMMERCIAL  
BROKERAGE • INVESTMENT • DEVELOPMENT



# SITE PLAN

# SABRE SPRINGS PLAZA

11385-11395 Poway Road, San Diego, CA

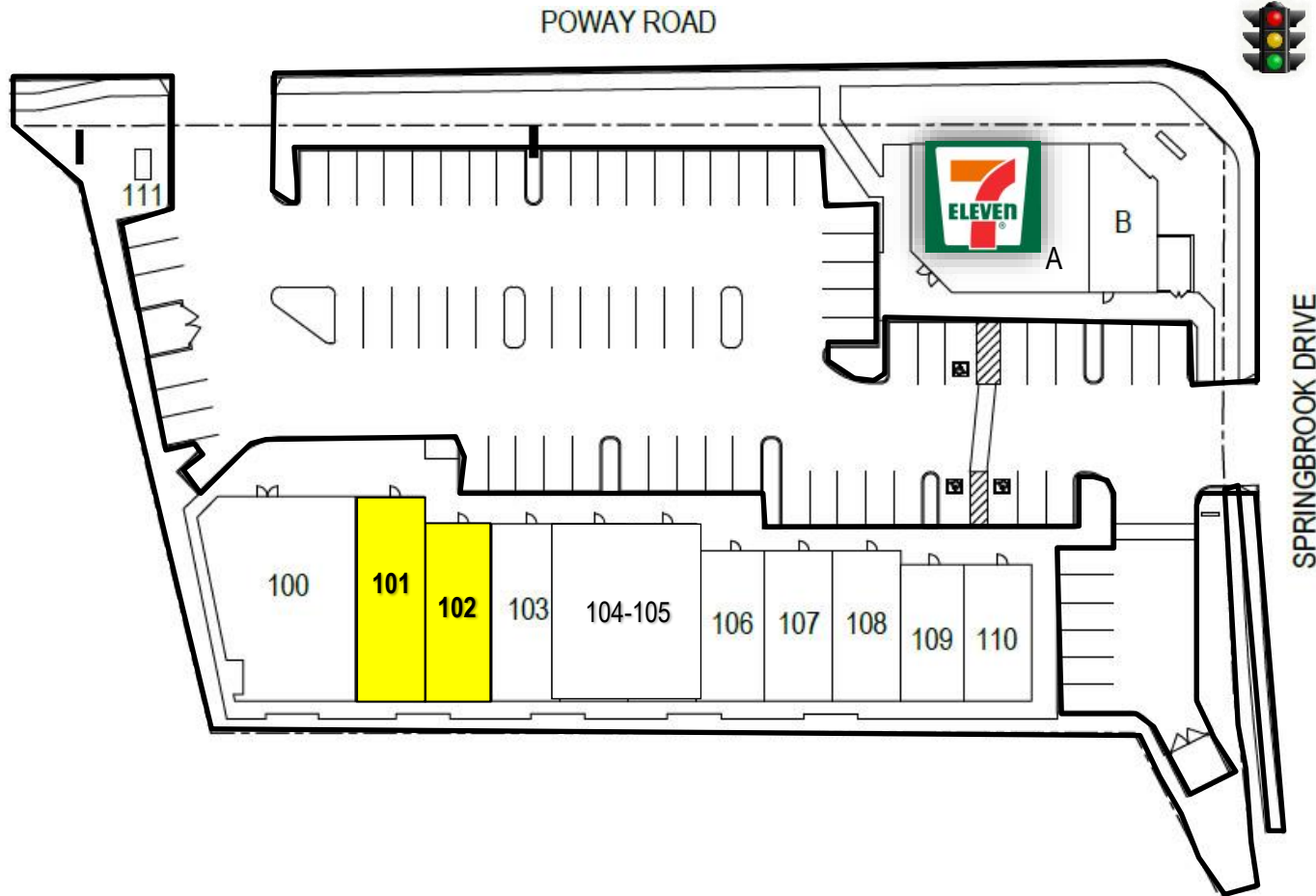

SUITE	TENANT	SF
100	Phileas Fogg's Bar & Restaurant	2,461
<b>101</b>	<b>AVAILABLE</b>	<b>1,200</b>
<b>102</b>	<b>AVAILABLE (Q3-2019)</b>	<b>1,040</b>
103	Mina Habibian, DDS	1,040
104-105	Poway Jewelry & Loan	2,080
106	Senor Taquero	880
107	French Nail & Spa	880
108	Auto Body Excellence	880
109	Eye Level Learning	790
110	HOB Coffee	800
111	Phone Repair Depot	50
A	7-Eleven	2,232
B	Tony's Barber Shop	706

Not Drawn to Scale

For more information about this property, please contact:

Rob Bloom  
 (619) 269-6076  
 Rob@DuhsCommercial.com  
 CA License: 01302163

Scott Duhs  
 (619) 491-0614  
 Scott@DuhsCommercial.com  
 CA License: 01048874



# DEMOGRAPHICS

# SABRE SPRINGS PLAZA

11385-11395 Poway Road, San Diego, CA



Population	1 Mile	2 Mile	3 Mile
2017 Total Population:	<b>12,515</b>	<b>51,478</b>	<b>115,635</b>
2022 Population:	<b>13,108</b>	<b>54,102</b>	<b>121,939</b>
Pop Growth 2017-2022:	<b>4.74%</b>	<b>5.10%</b>	<b>5.45%</b>
Average Age:	<b>35.50</b>	<b>36.80</b>	<b>37.60</b>
Households			
2017 Total Households:	<b>4,380</b>	<b>18,130</b>	<b>40,003</b>
Avg. Household Inc:	<b>\$141,508</b>	<b>\$129,398</b>	<b>\$129,776</b>
Avg. Household Size:	<b>2.80</b>	<b>2.80</b>	<b>2.90</b>
Housing			
Median Home Value:	<b>\$662,963</b>	<b>\$666,577</b>	<b>\$661,768</b>
Median Year Built:	<b>1995</b>	<b>1991</b>	<b>1988</b>

For more information about this property, please contact:

Rob Bloom  
 (619) 269-6076  
 Rob@DuhsCommercial.com  
 CA License: 01302163

Scott Duhs  
 (619) 491-0614  
 Scott@DuhsCommercial.com  
 CA License: 01048874

No warranty or representation is made to the accuracy of the foregoing information. Terms of sale or lease and availability are subject to change or withdrawal without notice.  
 3830 Ray Street, San Diego, CA 92104 | Phone (619) 491-0335 | Fax (619) 491-0696 | www.DuhsCommercial.com



# AERIAL

# SABRE SPRINGS PLAZA

11385-11395 Poway Road, San Diego, CA

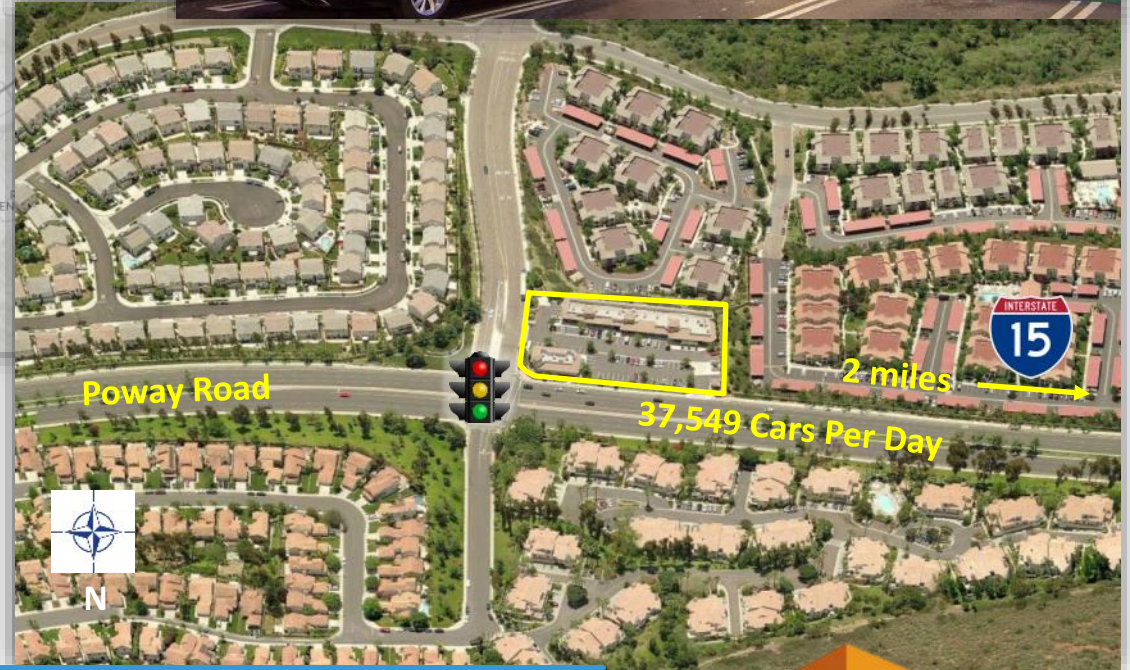
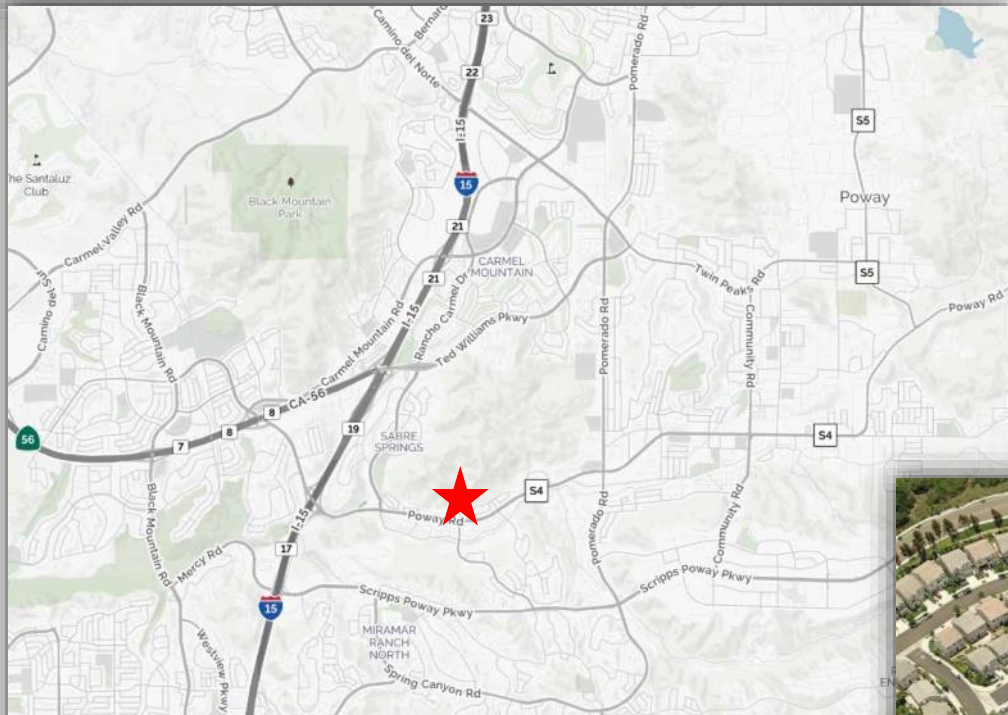

## 5 Schools within a 1-Mile Radius – 3,325 Total Students

- Creekside Elementary – 823 students
- Morning Creek Elementary – 573 students
- Innovations Academy – 350 students
- Dingeman Elementary – 832 students
- Scripps Elementary – 747 students

(Source: GreatSchools.org)

For more information about this property, please contact:

Rob Bloom  
(619) 269-6076  
Rob@DuhsCommercial.com  
CA License: 01302163

Scott Duhs  
(619) 491-0614  
Scott@DuhsCommercial.com  
CA License: 01048874



COMMERCIAL  
BROKERAGE • INVESTMENT • DEVELOPMENT