

FOR LEASE

WILD WEST VILLAGE

802-890 Jackman Street (Fletcher Pkwy and Marshall Ave) El Cajon, CA 92020

Highlights:

- Located One Block West of Westfield Parkway Shopping Center - A One Million Square Foot Mall
- Easy Access to I-8 and Route 67
- Five entrances and ample parking (5.75 / 1,000)
- Other Tenants in the Shopping Center Include: Salon Centric, Rock Church, Scripps Children's, Summit College, and many others.



Available: See Site Plan

For more information about this property, please contact:

Scott Duhs
(619) 491-0614
Scott@DuhsCommercial.com
CA License: 01048874



COMMERCIAL
BROKERAGE • INVESTMENT • DEVELOPMENT

SITE PLAN

WILD WEST VILLAGE

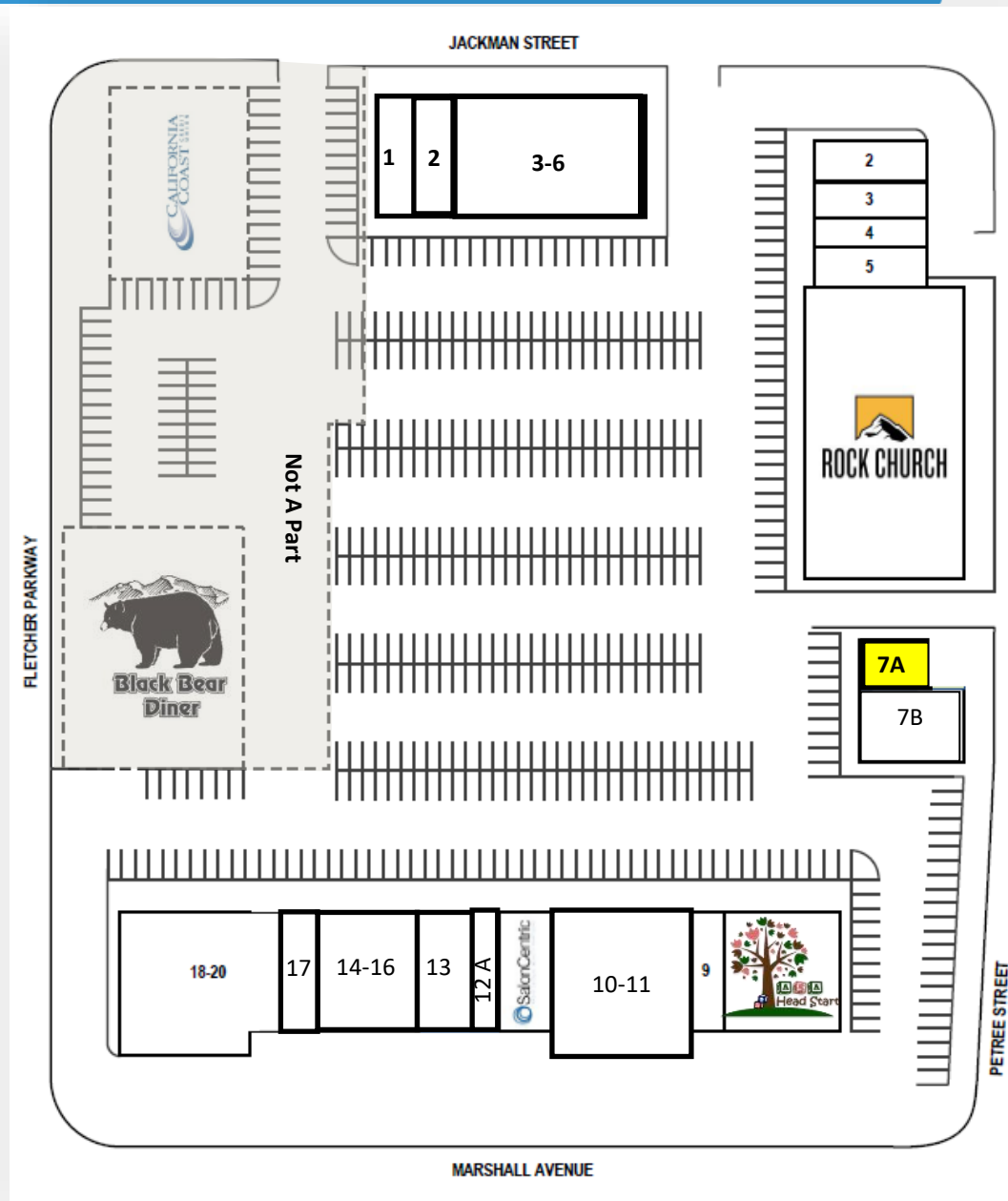

	SUITE	TENANT	SF	
	890	1	Tattoo	1,132
	886	2	Gym	3,284
	876-884	3-6	Summit College	7,574
	802-816		The Rock Church	22,816
	826	7A	AVAILABLE	1,738
	828	7B	Dentist	3,422
	832-838	8	AKA Head Start	5,530
	840	9	Foxy Nails	1,121
	844-848	10-11	Scripps Medical Offices	6,880
	850	12	Salon Centric	3,010
	852	12A	Adult Day Care	1,050
	854	13	Adult Day Care	2,100
	856-860	14-16	Adult Day Care	4,550
	862	17	Adult Day Care	1,050
	866-873	18-20	Chinese Restaurant	7,676



AERIAL

WILD WEST VILLAGE



Demographics:	1 Mile	3 Miles	5 Miles
Total Population:	14,755	176,441	373,764
Avg. HH Income:	\$70,943	\$71,155	\$81,829

Traffic Counts: Fletcher Pkwy = 24,313 ADT
Marshall Ave = 18,977 ADT

For more information about this property, please contact:

Scott Duhs
(619) 491-0614
Scott@DuhsCommercial.com
CA License: 01048874

