

FOR LEASE

OFFICE OR RETAIL
2828 UNIVERSITY AVENUE, SAN DIEGO, CA

HIGHLIGHTS:

- FULLY BUILT OUT OFFICE SPACES
- FORMER LAW OFFICE
- NORTH PARK IS ONE OF SAN DIEGO'S HOTTEST NEIGHBORHOODS!
- SPACE AVAILABLE FOR 653– 1493 SF, SEE SITE PLANS
- ON SITE PARKING



For more information about this property, please contact:

Rick Wu
(619) 491-0826

Rick@DuhsCommercial.com
CA License: 01495421

Scott Duhs
(619) 491-0614

Scott@DuhsCommercial.com
CA License: 01048874



No warranty or representation is made to the accuracy of the foregoing information. Terms of sale or lease and availability are subject to change or withdrawal without notice.
3830 Ray Street, San Diego, CA 92104 | Phone (619) 491-0335 | Fax (619) 491-0696 | www.DuhsCommercial.com



SITE PLANS

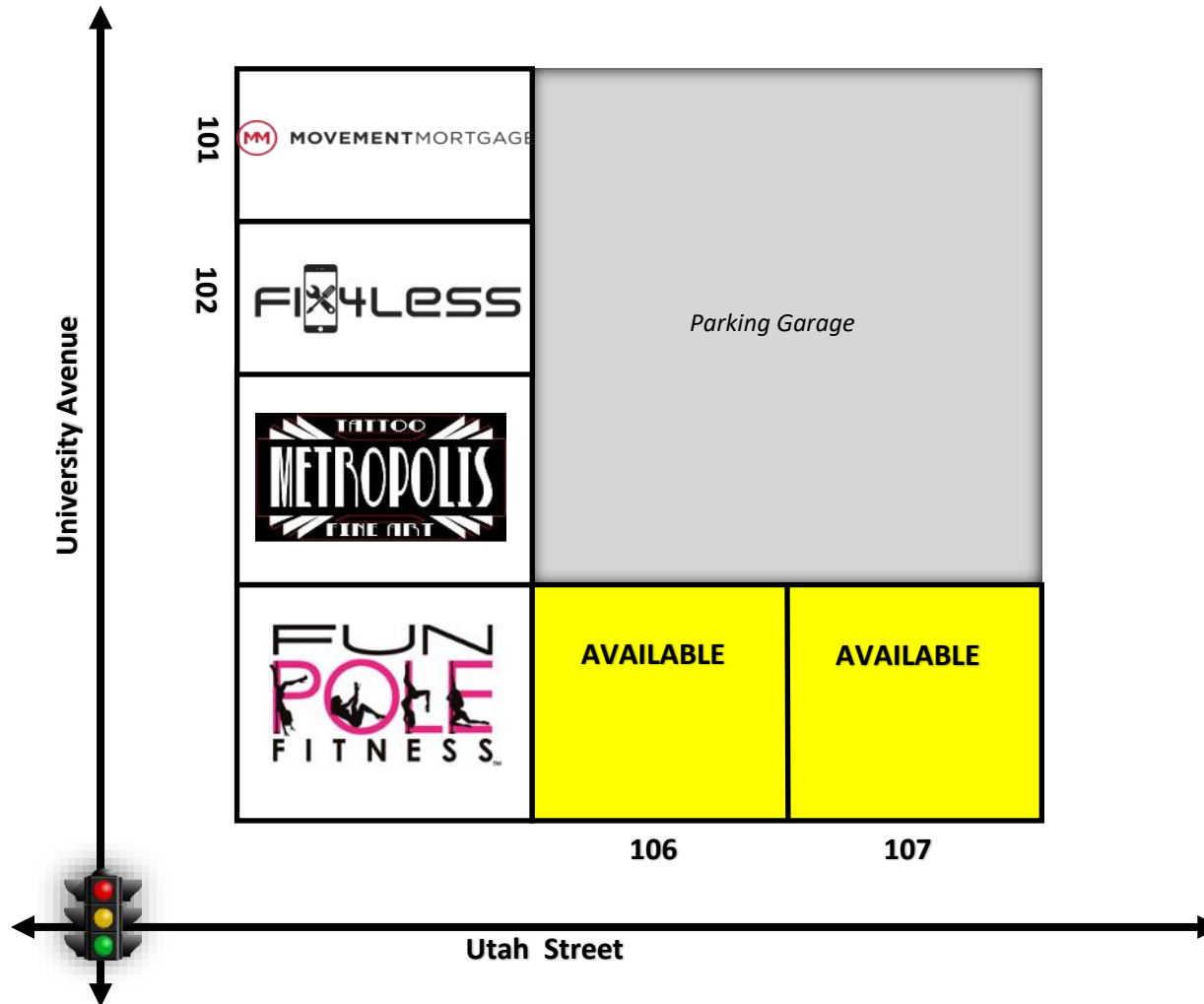

For more information about this property, please contact:

Rick Wu

(619) 491-0826

Rick@DuhsCommercial.com

CA License: 01495421

Scott Duhs

(619) 491-0614

Scott@DuhsCommercial.com

CA License: 01048874



FLOOR PLAN

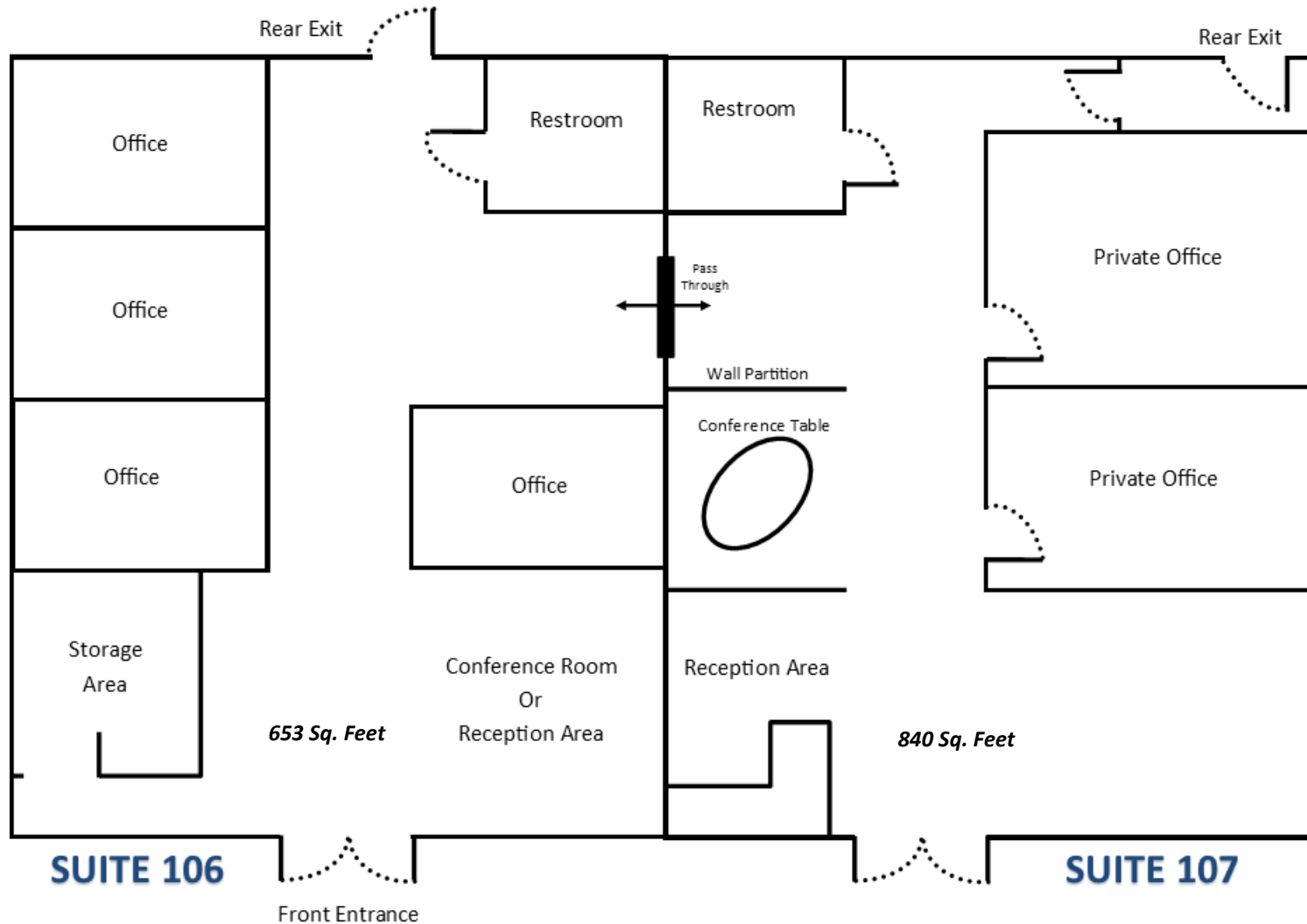

Not Drawn To Scale

For more information about this property, please contact:

Rick Wu
(619) 491-0826

Rick@DuhsCommercial.com
CA License: 01495421

Scott Duhs
(619) 491-0614

Scott@DuhsCommercial.com
CA License: 01048874



COMMERCIAL
BROKERAGE • INVESTMENT • DEVELOPMENT

FLOOR PLAN

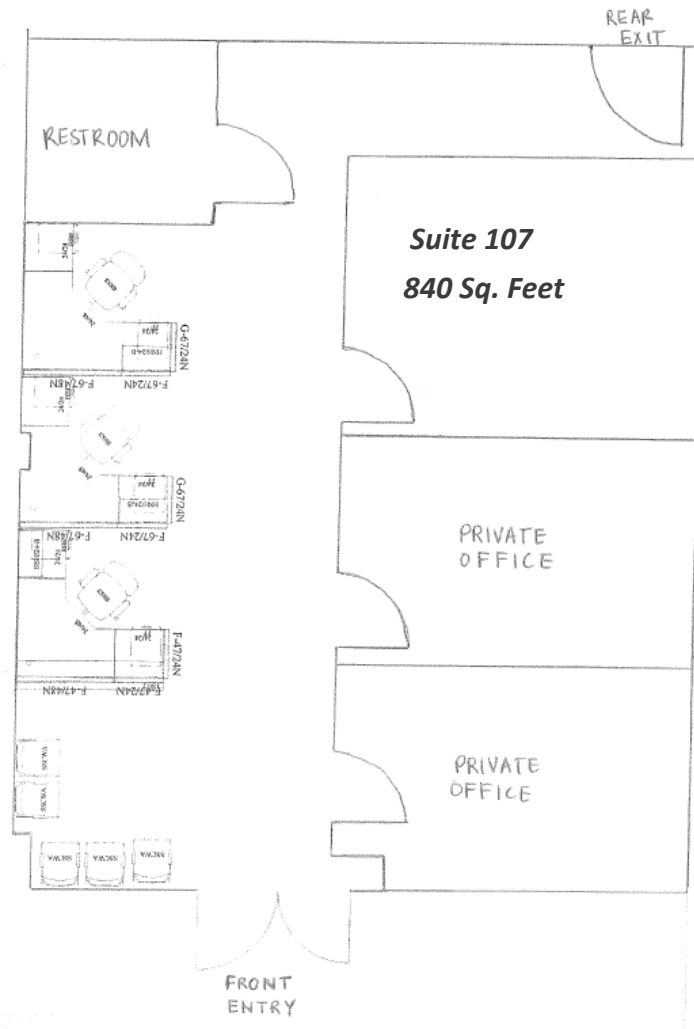

For more information about this property, please contact:

Rick Wu

(619) 491-0826

Rick@DuhsCommercial.com

CA License: 01495421

Scott Duhs

(619) 491-0614

Scott@DuhsCommercial.com

CA License: 01048874



Parking Lot

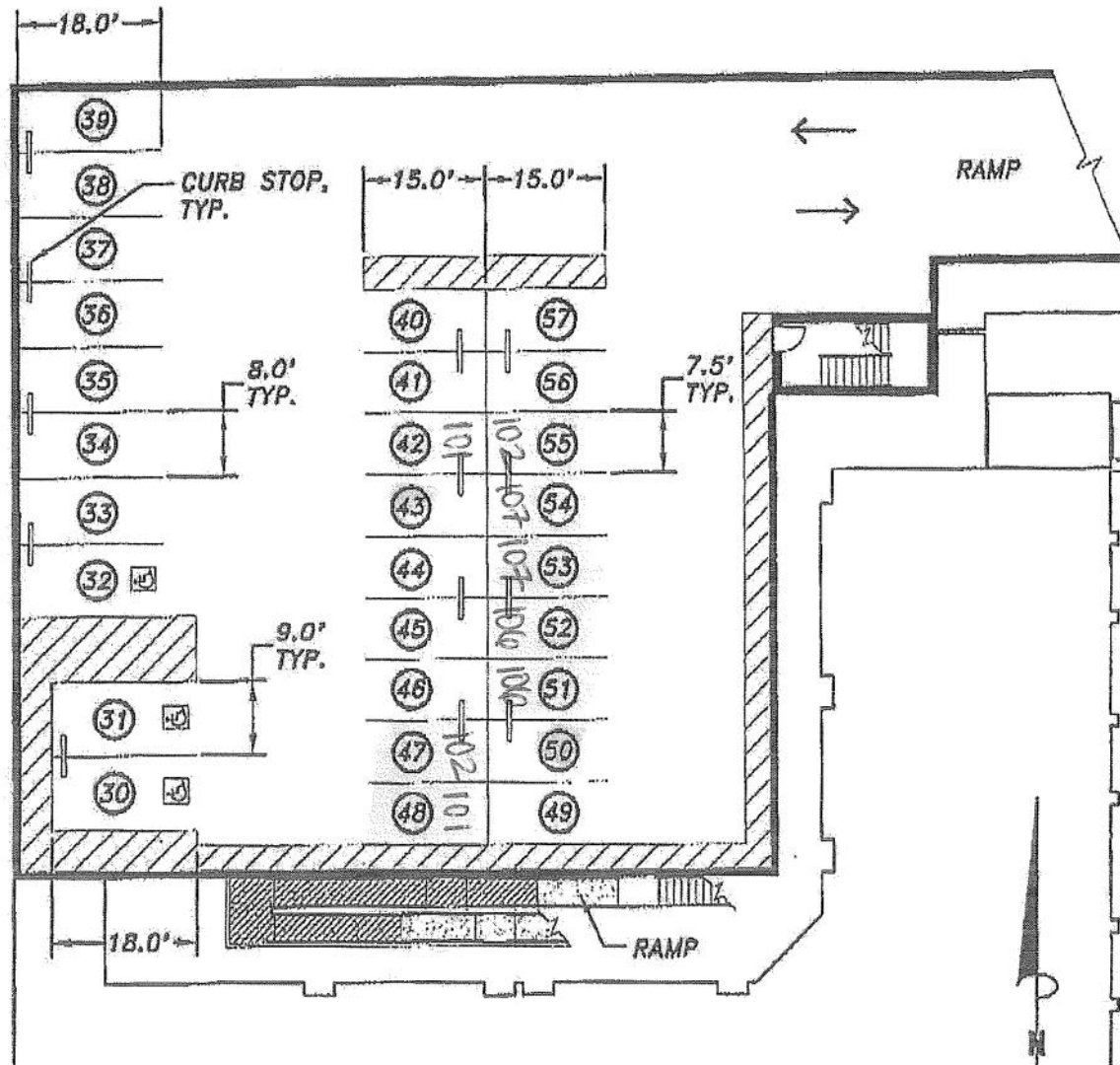

For more information about this property, please contact:

Rick Wu

(619) 491-0826

Rick@DuhsCommercial.com

CA License: 01495421

Scott Duhs

(619) 491-0614

Scott@DuhsCommercial.com

CA License: 01048874



AERIAL



For more information about this property, please contact:

Rick Wu
(619) 491-0826

Rick@DuhsCommercial.com
CA License: 01495421

Scott Duhs
(619) 491-0614

Scott@DuhsCommercial.com
CA License: 01048874



COMMERCIAL
BROKERAGE • INVESTMENT • DEVELOPMENT