

# FOR LEASE

3749 - 3795 MILL ST.  
RENO, NV 89502

EAGLE MILL INDUSTRIAL PARK - APPROX. 60,000 SF PROJECT & STORAGE UNITS/CONTAINERS AVAILABLE

Available: 2,505 SF - 5,595 SF

## HIGHLIGHTS:

- Storage units from 160-360 SF available
- Right next door to Reno Airport
- Great opportunity to convenient Industrial location
- High Ceilings

**JUST REMODELED**



**Craig Duhs**

Partner | CA License: 01086079

619.540.1001 | [Craig@DuhsCommercial.com](mailto:Craig@DuhsCommercial.com)



**COMMERCIAL**  
BROKERAGE · INVESTMENT · DEVELOPMENT

No warranty or representation is made to the accuracy of the foregoing information. Terms of sale or lease and availability are subject to change or withdrawal without notice.

3830 Ray Street, San Diego, CA 92104 | Phone (619) 491-0335 | Fax (619) 491-0696 | [www.DuhsCommercial.com](http://www.DuhsCommercial.com)

# SITE PLAN

3749 - 3795 MILL ST.  
RENO, NV 89502

EAGLE MILL INDUSTRIAL PARK - APPROX. 60,000 SF PROJECT & STORAGE UNITS/CONTAINERS AVAILABLE

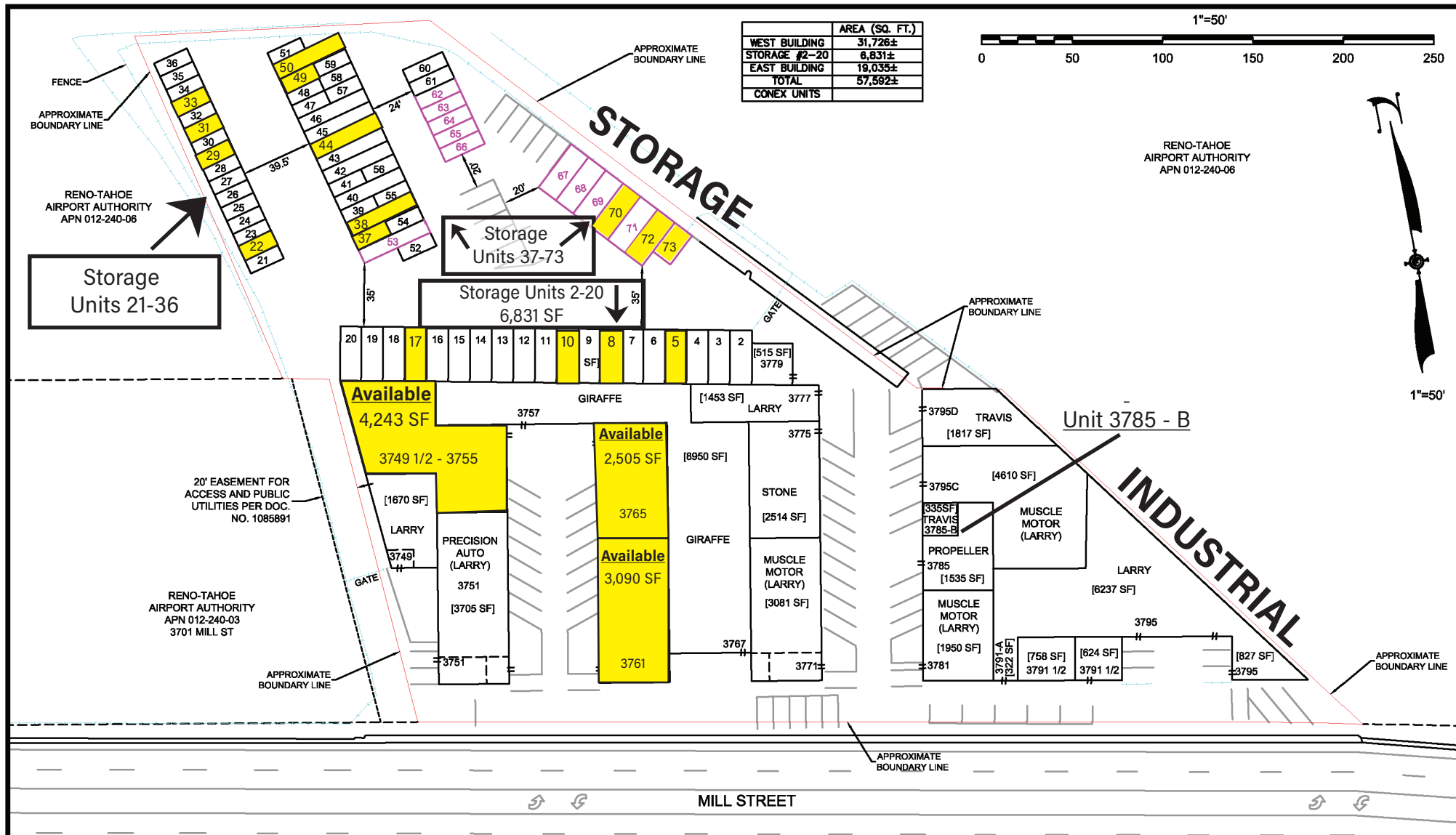

SCALE: 1"=50'  
JOB #: 30924  
DESIGNED BY: RGC  
CHECKED BY: RGC  
DRAWN BY: rook  
N:\DWGS\30924\_3791MillStMillConceptual20200727.DWG - 4:56 PM \* 27-JUL-2020

SITE DISPLAY  
3791 MILL STREET  
APN 012-240-05

SHEET  
1  
OF  
1

# SITE PLAN

3749 - 3795 MILL ST.  
RENO, NV 89502

EAGLE MILL INDUSTRIAL PARK - APPROX. 60,000 SF PROJECT & STORAGE UNITS/CONTAINERS AVAILABLE



SCALE: 1"=50'	DESIGNED BY: RGC
JOB #: 30924	CHECKED BY: RGC
	DRAWN BY: rcook
N:\DWGSU30924_3791MillStMillBMap20191126.DWG - 5:31 PM * 26-NOV-2019	

**SITE DISPLAY**  
**3791 MILL STREET**  
**APN 012-240-05**



# Photo

3749 - 3795 MILL ST.  
RENO, NV 89502

EAGLE MILL INDUSTRIAL PARK - APPROX. 60,000 SF PROJECT & STORAGE UNITS/CONTAINERS AVAILABLE



**Craig Duhs**

Partner | CA License: 01086079

619.540.1001 | [Craig@DuhsCommercial.com](mailto:Craig@DuhsCommercial.com)



**COMMERCIAL**  
BROKERAGE · INVESTMENT · DEVELOPMENT

No warranty or representation is made to the accuracy of the foregoing information. Terms of sale or lease and availability are subject to change or withdrawal without notice.

3830 Ray Street, San Diego, CA 92104 | Phone (619) 491-0335 | Fax (619) 491-0696 | [www.DuhsCommercial.com](http://www.DuhsCommercial.com)

# Photo

3749 - 3795 MILL ST.  
RENO, NV 89502

EAGLE MILL INDUSTRIAL PARK - APPROX. 60,000 SF PROJECT & STORAGE UNITS/CONTAINERS AVAILABLE



**Craig Duhs**

Partner | CA License: 01086079

619.540.1001 | [Craig@DuhsCommercial.com](mailto:Craig@DuhsCommercial.com)



No warranty or representation is made to the accuracy of the foregoing information. Terms of sale or lease and availability are subject to change or withdrawal without notice.

3830 Ray Street, San Diego, CA 92104 | Phone (619) 491-0335 | Fax (619) 491-0696 | [www.DuhsCommercial.com](http://www.DuhsCommercial.com)

# Photo

3749 - 3795 MILL ST.  
RENO, NV 89502

EAGLE MILL INDUSTRIAL PARK - APPROX. 60,000 SF PROJECT & STORAGE UNITS/CONTAINERS AVAILABLE



**Craig Duhs**

Partner | CA License: 01086079

619.540.1001 | [Craig@DuhsCommercial.com](mailto:Craig@DuhsCommercial.com)



No warranty or representation is made to the accuracy of the foregoing information. Terms of sale or lease and availability are subject to change or withdrawal without notice.

3830 Ray Street, San Diego, CA 92104 | Phone (619) 491-0335 | Fax (619) 491-0696 | [www.DuhsCommercial.com](http://www.DuhsCommercial.com)

# Aerial

3749 - 3795 MILL ST.  
RENO, NV 89502

EAGLE MILL INDUSTRIAL PARK - APPROX. 60,000 SF PROJECT & STORAGE UNITS/CONTAINERS AVAILABLE



**Craig Duhs**

Partner | CA License: 01086079

619.540.1001 | [Craig@DuhsCommercial.com](mailto:Craig@DuhsCommercial.com)



**COMMERCIAL**  
BROKERAGE · INVESTMENT · DEVELOPMENT

No warranty or representation is made to the accuracy of the foregoing information. Terms of sale or lease and availability are subject to change or withdrawal without notice.

3830 Ray Street, San Diego, CA 92104 | Phone (619) 491-0335 | Fax (619) 491-0696 | [www.DuhsCommercial.com](http://www.DuhsCommercial.com)