

FOR SALE

Highlights:

- Ready for Building Permits
- Located along the busiest Trolley Line in San Diego
- Zero (0) Parking Required
- FAR 6.5
- 0.96 Acres
- 45-100 units By Right



Iris Ave.

Howard Ave.

30th St.



CALIFORNIA 905

CALIFORNIA 905

CALIFORNIA 905

Transit Oriented Development Apartment Site

1507 Howard Ave., San Diego, CA 92173

Austin Dias

(619) 269-6077 • Austin@Duhscommercial.com



COMMERCIAL
BROKERAGE • INVESTMENT • DEVELOPMENT

SITE SOURCE
REAL ESTATE NETWORK

Example Project Summary

1507 Howard Ave., San Diego, CA 92173

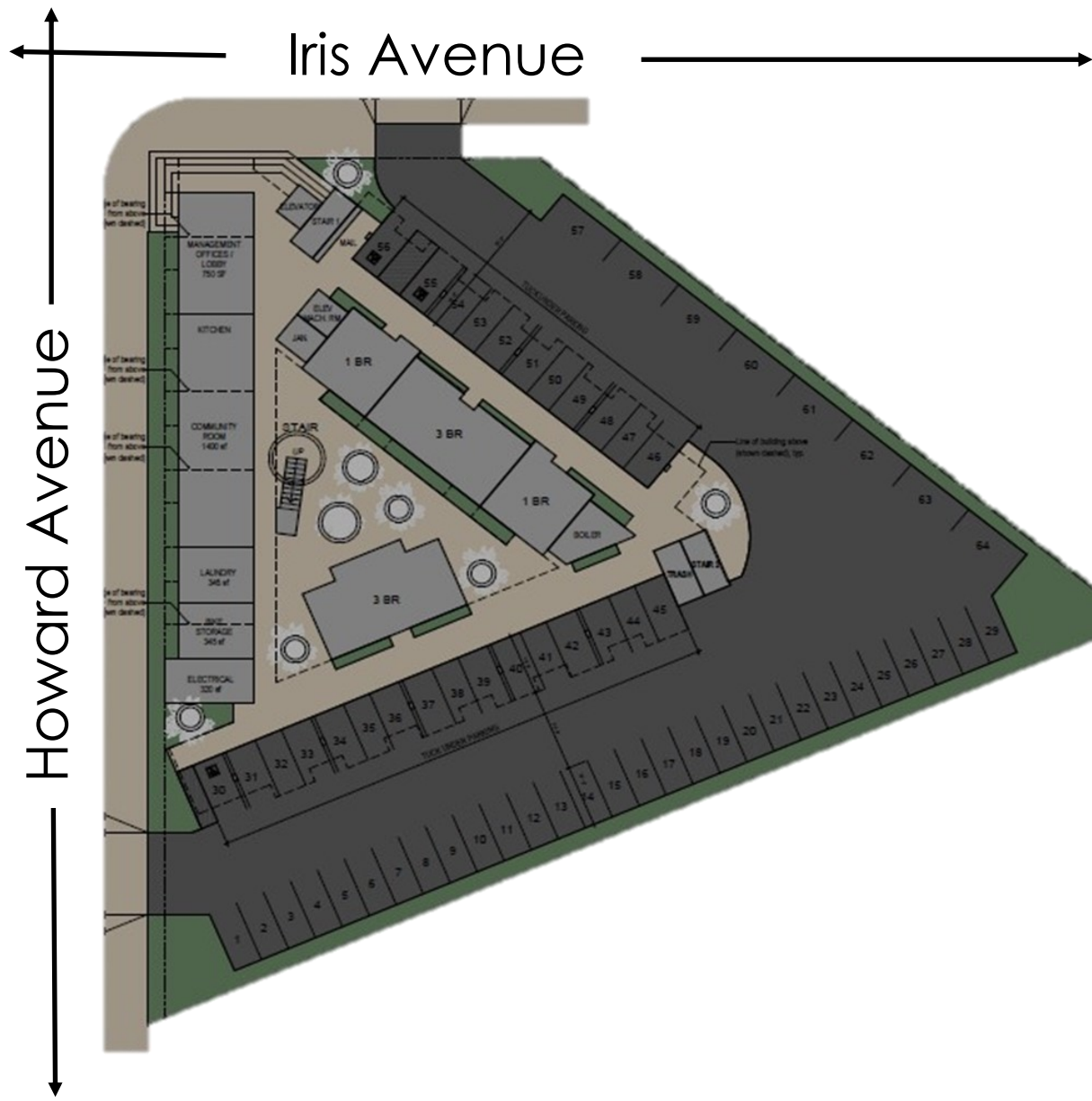

DATA SUMMARY:

Address: 1507 Howard Avenue, San Diego, CA 92173

Zone: CN 1-2 (Mixed use - commercial required but possible to use incentive)

Per Ch. 14 SD Zoning Code and Call with the City of SD:
Ch. 14 - complete communities - Tier 3 - FAR 6.5
either provide linear public park, or pay fees to offset
15% very low; 15% low; 10% moderate

Height limit: none required

Setbacks: none required

Incentives requested:
-private open space
-common open space
-mixed use

Lot area: 0.96 acre lot (41,818 sf)

APN: 6370204700

Legal Description: (EX SCC332760&ST)LD SW OF RR RW IN NWQ OF NWQ NWQ SEC 35-18-2W

FAR: Allowed - 6.5
[Can go up to 271,817 sf based on lot area]

Parking: Provided 64 spaces (1 per unit)

Unit Mix:
44 1 Bedroom (520 sf)
12 2 Bedroom (750 sf)
8 3 Bedroom (957 sf)

64 Units Total

Building Area:
Level 1 7192 sf
Level 2 16,335 sf
Level 3 16,335 sf
Level 4 16,335 sf

Total Gross Building Area: 56,197 sf

Example Project Floors 2-4

1507 Howard Ave., San Diego, CA 92173

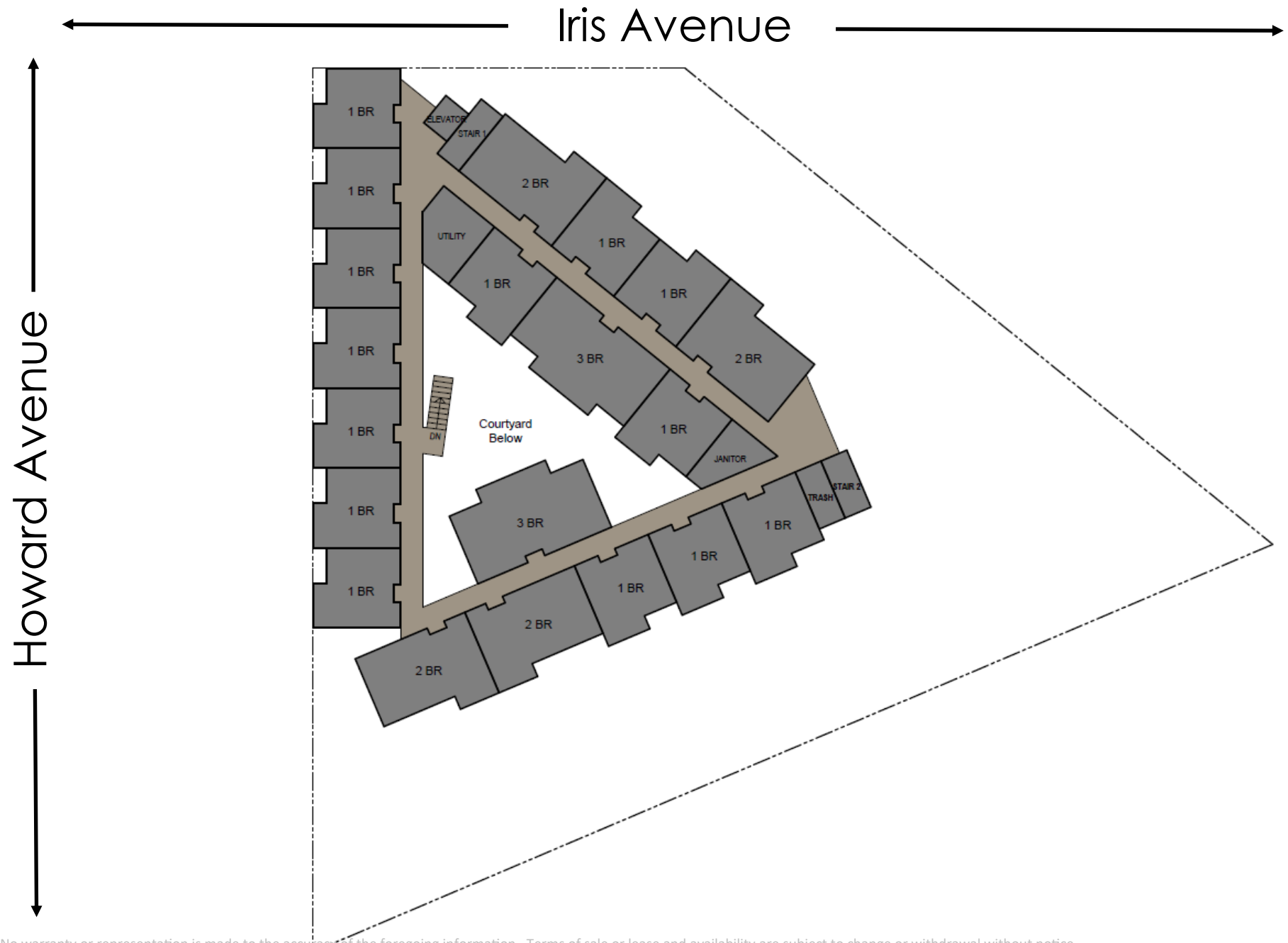

AERIAL

1507 Howard Ave., San Diego, CA 92173

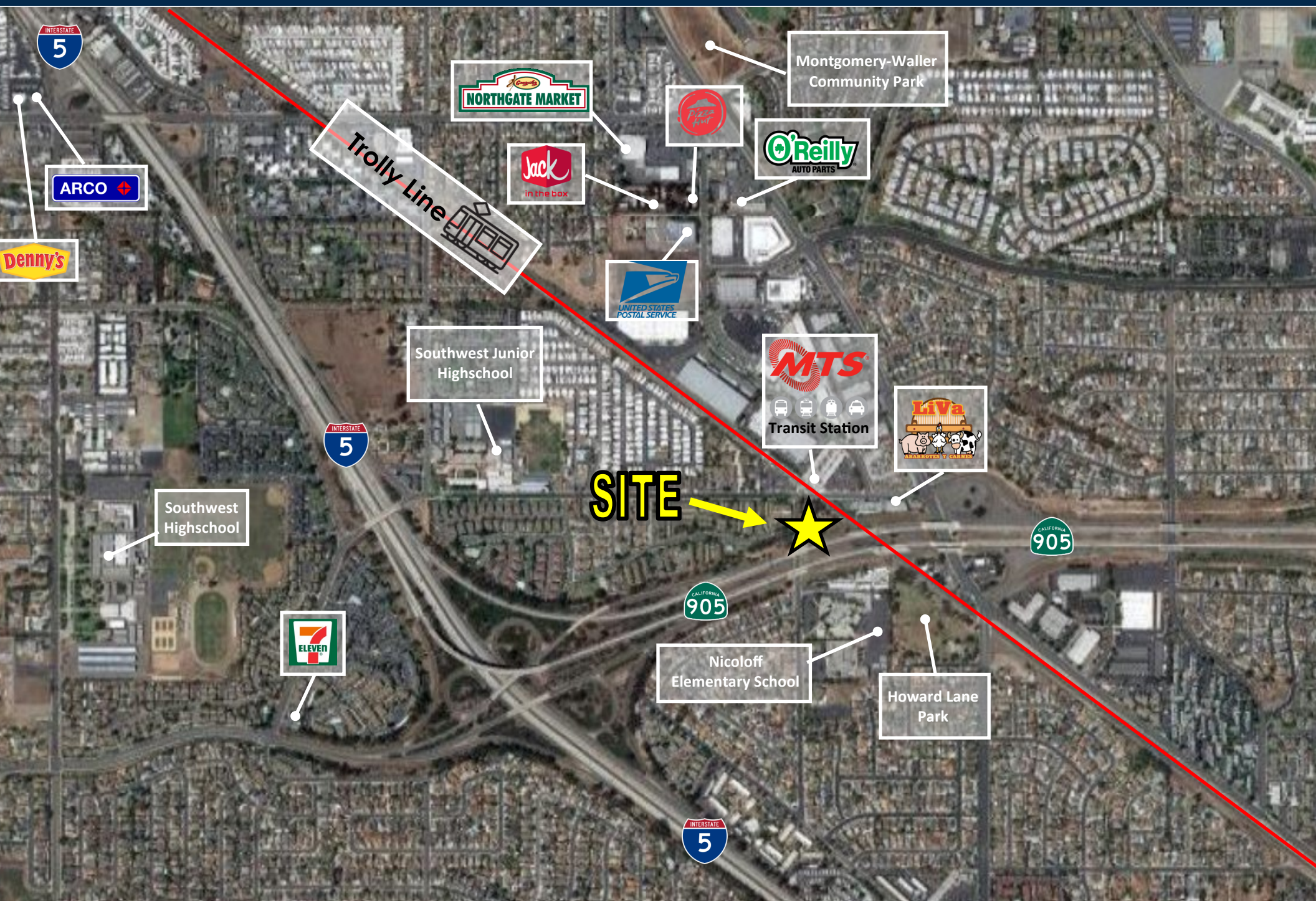

Map

1507 Howard Ave., San Diego, CA 92173

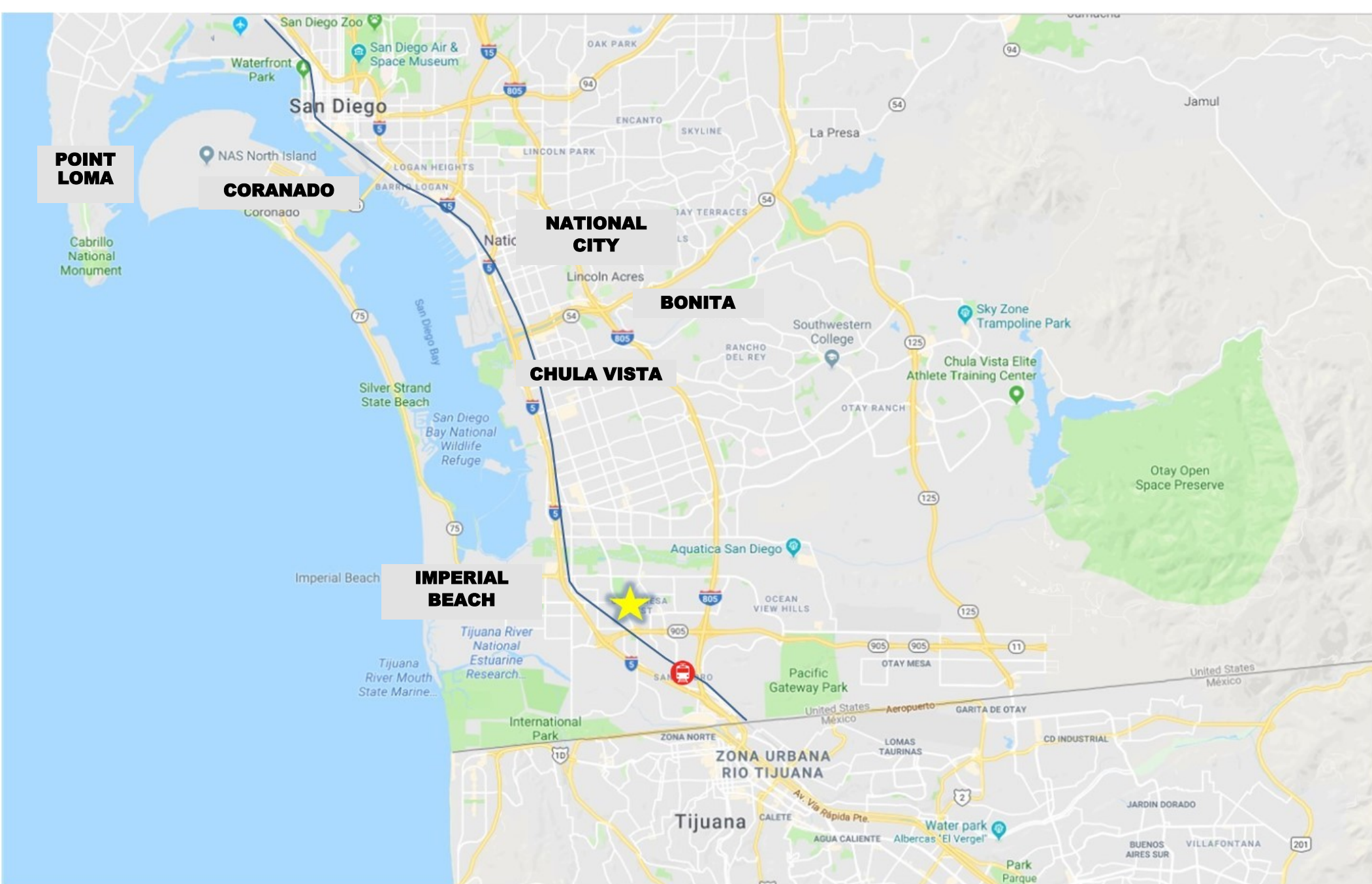

Transit Oriented Development Apartment Site

1507 Howard Ave., San Diego, CA 92173

Austin Dias

(619) 269-6077 • Austin@Duhscommercial.com

Available Documents

Architectural Feasibility Study

Preliminary Engineering Plans

Phase 1 and Limited Soil Sampling

Historical Report

ALTA Survey

Caltrans Letter